

# Trinity District at Lakeview

507-515 Lakeshore Rd East, Mississauga, ON

Steps away from the shores of Lake Ontario at Lakeshore Rd. E, west of Cawthra Road in an affluent cross-section of South Mississauga. Trinity District at Lakeview is a mixed-use development providing an opportunity for a high traffic retail location. Opportunity exists to join the strong existing mix of retail tenants with immediate possession. Quesada, Tahini's, and Chatime are now open, adding great retail uses to the tenant roster.

## Size

Retail	140,000 s.f.
Office	28,000 s.f.
Residential (Kingsmen – 280 units)	265,000 s.f.
Total GFA	433,000 s.f.

## Opened

Fall 2016/Spring 2017

## Major Tenants

PetSmart	13,100 s.f.
Casual Life	4,900 s.f.
Bank of Montreal	3,500 s.f.
PharmaChoice	2,900 s.f.
Orange Theory Fitness	2,800 s.f.
East Credit Veterinary Centre	2,250 s.f.
Popeyes	2,000 s.f.
Sunset Grill	2,000 s.f.
Coffee Culture	1,800 s.f.



## Demographics

	1 km	3 km	5 km
Total Population	9,453	46,688	137,565
Number of Households	4,121	19,429	53,694
Average Household Income	\$114,619	\$129,999	\$122,478
Median Age	42.5	42.9	41.7

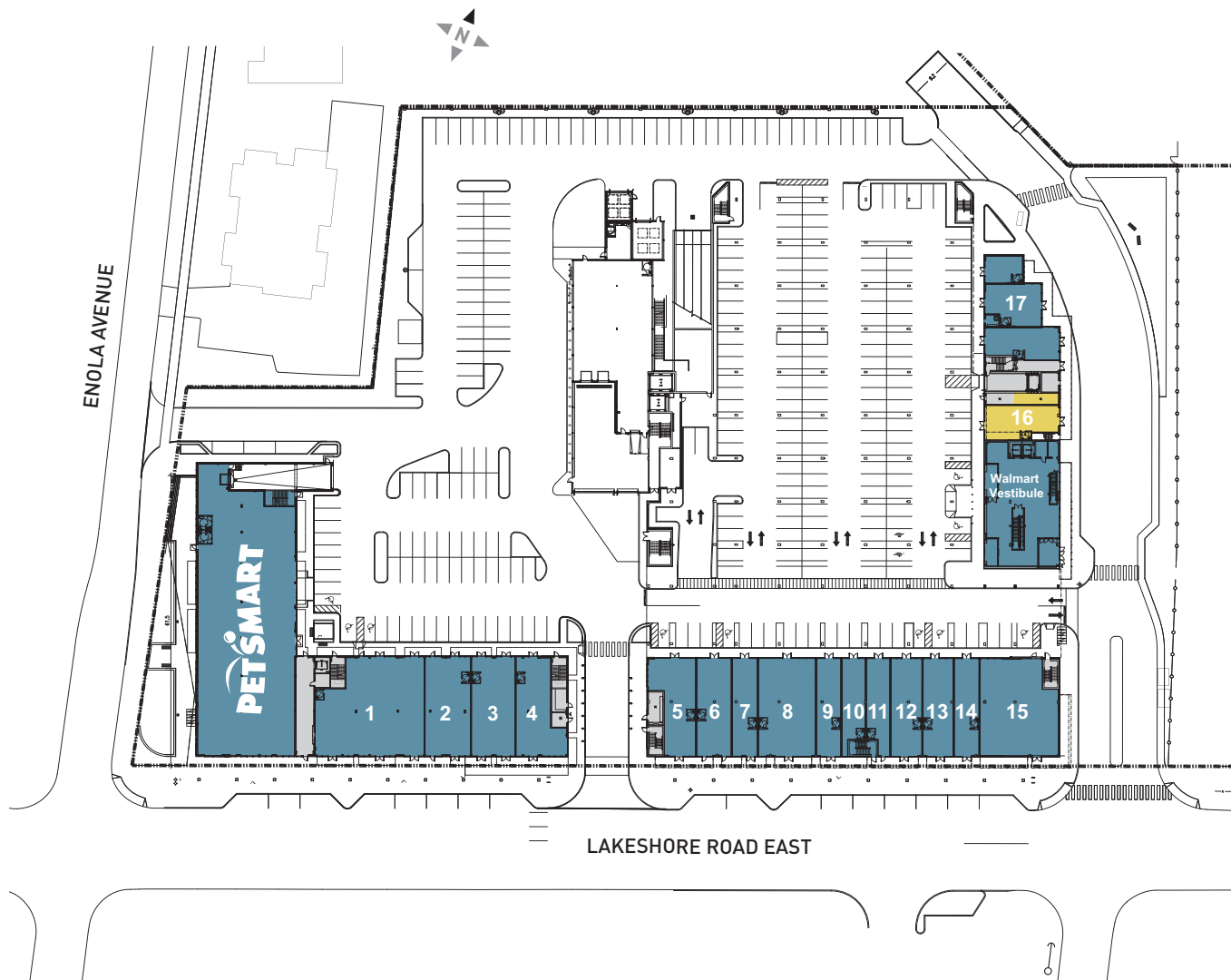

## GROUND LEVEL

■ Retail Leased ■ Retail Available

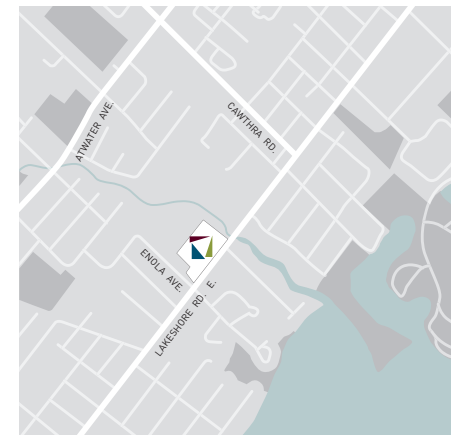

## Tenants: Ground level

### PetSmart

1. Casual Life
2. East Credit Veterinary Centre
3. Popeyes
4. Sunset Grill
5. Coffee Culture
6. Tahini's
7. Nails for You
8. Orange Theory
9. Optical
10. Chatime
11. Fuzz Wax Bar
12. Quesada
13. Dentist
14. Physio
15. BMO
- 16. Available 1,370 s.f.**
17. PharmaChoice

# Trinity District at Lakeview

507-515 Lakeshore Rd East, Mississauga, ON

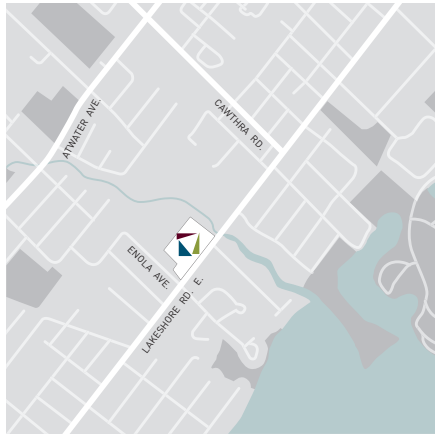

## Tenants: Second Level

Walmart

1. Available 3,928 s.f.
2. Lawyer's Office
3. Owen Media
4. Blyth Academy
5. Sola Hair Salon
6. Vermillion Medical Spa
7. Aquility
8. The Root Natural Health Clinic
9. Blyth Academy



## SECOND LEVEL

■ Retail Leased ■ Retail Available



VIEW FROM LAKESHORE ROAD EAST